

### Functional test after installation

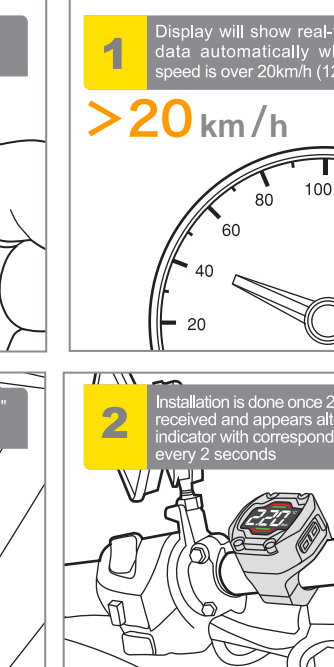

### FCC warning statement

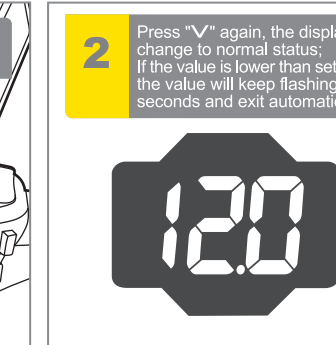
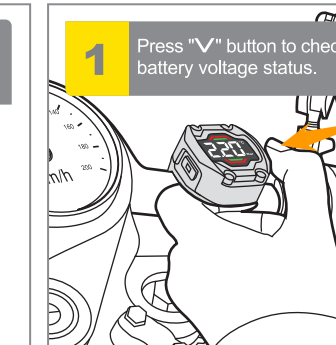

**Air pressure unit:**  
1 Bar = 14.5 PSI = 100K Pa = 1.02 Kgf / cm

- Reorient or relocate the receiving antenna
- Increase the separation between the equipment and receiver
- Connect the equipment into an outlet on a circuit different from that to which the receiver is connected
- Consult the dealer or an experienced radio / TV technician for help